

# MARSH®

## Test Gauges



### Description

Precision Bourdon Tube Test gauge. Class 0.25% Models. BSC/TG SSC/TG

According to DIN EN 837-1 Nominal sizes, 160 and 250 mm Accuracy: Class 0.25

### Features

Rugged stainless steel or black steel case construction

Bayonet locking case and bezel

Protection to IP54

Usable at full scale

Beryllium copper bourdon tube

Over-range protection 130% Ranges

### Ranges

-1...0bar. Up to 0...1000 bar

-30 in Hg...0. PSI up to 0...15000 psi

### Applications

Inspection and testing

### Specifications:

	BSC/TG	SSC/TG
Dial Size	160	250
Construction	Flush fitting bayonet locking case and bezel, safety blow out disc, DIN-EN 837 S1	
Measuring Element	Bourdon Tube	
Ranges {bar}	0,6. 1. 1,6. 2,5. 4. 6. 10. 16. 25. 40. 60. 100.. 160. 250. 400. 600. 1000.	
Over-range limit	130% full scale...short periods	
Process Connection	1/4bsp, 3/8bsp, 1/2bsp according to EN837 1/4npt, 1/2npt, according to ANSI/ASME B1.20.1	
Material Construction		
Process Connection	Brass	
Bourdon Tube	Beryllium Copper, C shape to 100 bar, coiled to 1000 bar.	
Case / Bezel Ring	Steel, black finish or Stainless steel AISI 304L.	
Window	Instrument glass, optional, laminated safety glass, acrylic glass.	
Dial	Aluminium, black figures on white, optional, anti-parallel mirror band.	
Pointer	Aluminium, black, balanced.	
Movement	Precision brass.	
Accuracy	Class 0.25 (0.25% F.S..D.)...optional class 0.6 (0.6%)	
Permissible	Degree C	
Ambient Temp.	-17 - 23.	
Process Temperature	Min. -30, Max. +100	
Storage Temperature	-40, +60	
Temperature Effect	Max...0,2% / 10 Deg C	
Protection	EN 60 529 IP54	
Filling Liquid	N /A	
Mountings	Direct bottom, direct back, surface, flush panel, panel fixing	
Weight dry / filled {kg}	1.2	2.3
Accessories	160mm full safety pattern case, other pressure units, mirror scale	

All specifications are subject to change without notice

FPM / 3H / V

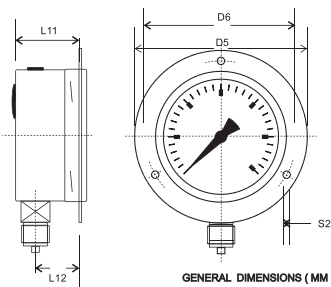

GAUGES WITH BOTTOM CONNECTION

DM / V

SM / V

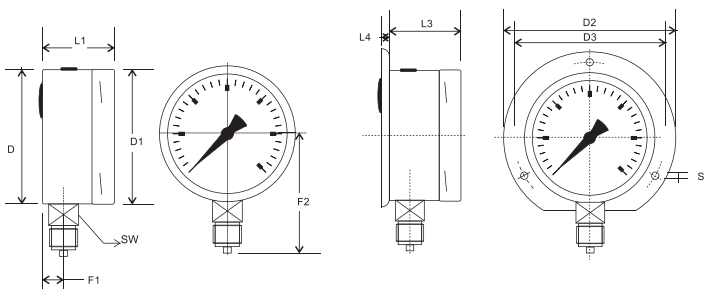

	D	D1	D2	D3	D4	D5	D6	L1	L2	L3	L4	L5	L6
63													
100													
160	159	161	192	178	167	192	178	52	52	50	5.5	5.6	4.9
250	250	253	289	276	265	289	276	55	55	55	3.0	5.8	5.1
	L7	L8	L9	L10	L11	L12	F1	F2	F3	F4	S1	S2	SW
63													
100													
160	40	4	47	6	47	30	15	119	40	45	6	6	2.2
250	40	7	49	6	49	31	16	164	40	45	6.5	6.5	2.2

For Panel Cut - Out Size, Add 1 mm to D1

**MARSH BELLOFRAM®**

Group of Companies

9 Castle Park Queens Drive, Nottingham NG2 1AH England

Tel: (44) 115 993 3300 • Fax: (44) 115 993 3301 • e-mail: bellofram@aol.com • www.marshbellofram.com

LTUK09023